

GENERAL INFORMATION



WINDOW WATCHER™

Designed to reinforce positive energy habits while limiting landlord energy expenses.

WRP Series

System Matched for King heaters

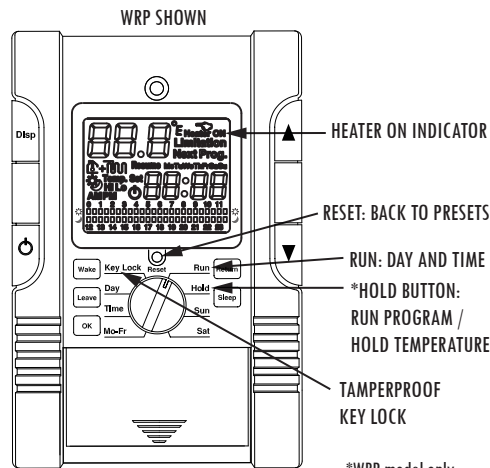

SPECIFICATIONS:

Temperature range: 40° to 75°F
 Temperature Default: Your set point /60°/40°
 Display Format: Liquid Crystal Display (LCD)
 Display size: Large Format
 Sample Rate: Every 60 seconds
 Delay on or off: 3 minutes
 Heat indicator: LCD "heater on"
 Relay Rating: 16 Amps inductive/resistive
 Accuracy: ± .9°F
 Maximum Amps: 16 inductive continuous
 Maximum Watts: 3840 @ 240V or 1 hp
 3328 @ 208V or ¾ hp
 Total inductive motor load combined can not exceed 16 Amps
 Minimum Watts: 0
 Power Supply: 208 to 240 Volts AC
 200 to 250 Volts AC

⚠ DANGER ⚠
ELECTRIC SHOCK OR FIRE HAZARD
 READ ALL WIRE SIZING, VOLTAGE REQUIREMENTS AND SAFETY DATA TO AVOID PROPERTY DAMAGE AND PERSONAL INJURY

GENERAL INFORMATION:

This thermostat is designed to reinforce positive energy habits while limiting landlord energy expenses. For use on 208 / 240 Volt AC and a total of 16 Amps load inductive continuous.

Almost all residential application electric heaters installed as original equipment by an electrician will be 208 or 240 Volt. It is very rare that a home, apartment or condominium would be wired with all 120 Volt heaters. Check the voltage to make sure you have the right thermostat for your heater voltage. A 2-pole or double-wide circuit breaker at the panel indicates a 240 Volt circuit; A 1-pole or single-wide breaker indicates a 120 Volt circuit. There are some exceptions to this rule; Check with a voltmeter to determine accurate phase to phase voltage.

Be safe and smart! Electricity can cause severe injury or death if not treated with respect and caution.

This thermostat will provide years of comfort control for your family in use with small fan-driven electric heaters, baseboards, radiant ceiling or wall panel heaters, cove heaters, or any line voltage resistance heating systems that do not have an electric motor over 1/3 hp.

OPERATION:

The WINDOW WATCHER™ is a precision electronic thermostat and uses a very sensitive thermistor to sense room air temperature, sending the information on to a microprocessor. As the temperature drops, the information sent will indicate if heat is needed. To reduce any undesirable fast on/off cycles, the processor has a built-in delay, up to 3 minutes. This saves energy and provides the best temperature control of an area.

The WINDOW WATCHER™ thermostat has an extra contact terminal block for remote set back to 40°F. Intended for window or door open contacts. The 40°F temperature is a fixed setting and not adjustable. The maximum operating temperature is stopped at 75°F, helping to change human behaviors that increase energy costs. *The day and time of day can be adjusted by selecting the TIME position and using the ▲ ▼ arrow keys. For an override, the ▲ UP arrow increases temperature and the ▼ DOWN arrow reduces temperature without any need to re-adjust the programming.*

The thermostat may take a few hours to stabilize the room temperature; Do not be alarmed when the thermostat does not show the correct temperature immediately after installation.

INSTALLATION:

This line voltage device should be installed and serviced by a qualified electrician. The thermostat has been designed to mount to a standard 2" x 4" electrical outlet box. Leveling of the thermostat is not required. #6-32 Phillips head mounting screws are provided.

Mount the thermostat in an open area about 5 feet above the floor, avoiding outside walls as they are too cold and will inhibit the thermostat's performance. A good rule of thumb is to place the thermostat above the wall switch for that room. This works well for most bedrooms, making it very convenient to turn the heat lower upon leaving. Avoid mounting the thermostat where there may be plumbing pipes in the wall, or placing a lamp or TV too close to the thermostat. Heat from such items negatively affects the thermostat's performance.

INSTALLATION AND MAINTENANCE



WINDOW WATCHER™

WRP Series

System Matched for King heaters



DANGER



ELECTRIC SHOCK OR FIRE HAZARD

READ ALL WIRE SIZING, VOLTAGE REQUIREMENTS AND SAFETY DATA TO AVOID PROPERTY DAMAGE AND PERSONAL INJURY

DISPLAY LEGEND - WR & WRP

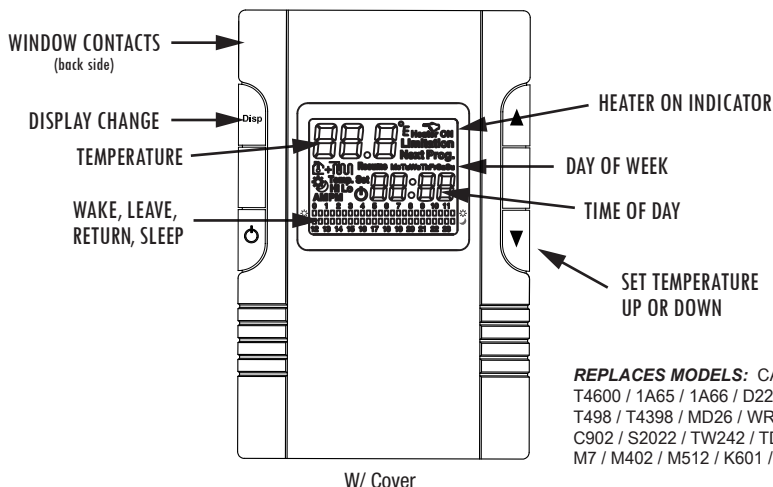

⚠ WARNING ⚠

READ CAREFULLY - These instructions were written to help prevent difficulties that might arise during thermostat installation. Studying the instructions first may save considerable time and money later. Observing the following procedures will keep installation time to a minimum. Save these instructions for future use.

Thank you for buying this King WINDOW WATCHER™ thermostat. This thermostat is designed to reinforce positive energy habits while limiting landlord energy expenses. It should provide years of service and comfort to your home. Inspect the package. Enclosed should be the thermostat with its cover and two screws.

1. Check the total load of the heaters being connecting to the thermostat. The maximum wattage at 240 Volt is 3840 Watts, 208 Volt is 3328 Watts, and 16 Amps. It is important to stay below this total wattage when connecting the thermostat. Lower wattage prolongs the the life of the contacts in the relay.
2. To wire the thermostat determine which pair of wires are coming from the breaker panel and which pair lead to the heater. See *Wiring Instructions*.
3. Remove cover of thermostat by placing thumb on LCD display and fingers on top edge of cover. Pull towards you. This will expose the top mounting screw.
4. There may be a pair of white wires connected in your junction box. If so, leave them alone and, at this time, work with the black wires.
5. Take a black lead from the circuit breaker panel and attach it to the black lead on the thermostat.
6. Take the other black heater lead and attach it to the red lead on the thermostat. This will provide power to the heater when the thermostat calls for heat. Add blue wire to both white wires to provide power to electronics.
7. Push the wires carefully into the junction box making sure no wires are pinched or will obstruct the screws mounting the thermostat. Now attach the thermostat to the wall using the #6-32 Phillips head screws provided. Replace cover. Do not over tighten screws.
8. Replace cover after setting time and programming.
9. Turn on power. Test by increasing set point to higher than current room temperature by tapping the ▲ Up button. There will be up to a 3 minute delay in turning on. You will hear a small click and "Heater On" will appear in the LCD; the heater should be on now. Turn the thermostat down by tapping on the ▼ Down arrow.
10. You have now verified the thermostat is in perfect working order and ready for years of trouble-free operation.
11. **Mounting tips:** Make sure nothing is nearby (a.g. plumbing pipes in the wall, a lamp close by, direct sunlight, a T.V. set, and/or cold drafts from a door opening) that could affect the average room temperature sensing of the thermostat. Typically the best, most convenient location is on inside walls above the light switch for that room.
12. **Cleaning:** Canned compressed air works great to clear any dust accumulation, while a damp cloth will additionally clean the plastic case surface of finger prints. Strong spray cleaners may damage the plastic case or remove writing or arrows screen-printed on case. Blow out any dust that may accumulate on top or bottom air vents. Good air circulation is key to long life and accurate operation.
13. **Humid locations:** Mildly humid location like bathrooms may reduce life due to corrosion on the contact and lint from towels getting into thermostat air vents. To extend life blow out vent regularly and mount thermostat away from shower locations.
14. **Purpose:** This thermostat is designed to reinforce positive energy habits while limiting landlord energy expenses.

WRP230 WINDOW WATCHER™ PROGRAMMING INSTRUCTIONS

PATENT APPLIED FOR

1 Comfort ☀ and Economy 🌙 Setting

To adjust setup (comfort) and setback (economy) temperatures.

- Turn rotary switch to START.
- Press twice to enter ☀ room temperature "HI" (comfort) setpoint. Press ▼ or ▲ to adjust. Press to exit.
- Press twice to enter 🌙 room temperature "LO" (economy) setpoint. Press ▼ or ▲ to adjust. Press to exit.
- Wait 5 seconds after adjusting the temperature. The thermostat shall memorize setting and return to the main screen.

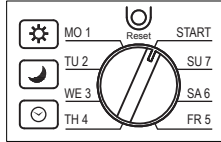

This thermostat has only two air temperature settings: 7 independent days and 30 minute increments. Users can adjust Comfort ☀ and Economy 🌙 time to their schedule many times per day.

2 Clock

- Turn indicator on rotary switch to "START".
- Press to enter clock programming.
- Press ▼ or ▲ to select the day of the week.
- Press again to adjust hour of day.
- Repeat pressing and ▼ ▲ to finishing setting the time.
- LCD display shall automatically memorize the setting and return to the main screen 5 seconds after time is set.

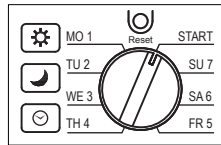

3 Independent Daily Time Schedule Setting

If the dial is left in anything but the START position it will default to "ERR" (Error). Turn to START to clear Error and restart programming.

Factory default settings are 70°F/21°C ☀ and 61°F/16°C 🌙.

- Turn indicator on rotary switch to the desired week day to begin programming time.
- Press or to alter the setting between ☀ and 🌙 on the LCD display.
- Press ▼ or ▲ to select each individual time schedule. Each time schedule will be indicated by flashing symbols.
- After setting all 7 days of the week turn rotary switch to "START". The thermostat will now start to operate its program.

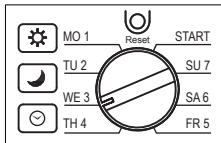

4 Hold

Press "HOLD" for constant temperature. 40° window switch can still override.

5 Manual (Temporary Override)

- Turn indicator on rotary switch to "START".
- Press ▼ or ▲ to indicate current ☀ or 🌙 temperature settings.
- Press ▼ or ▲ to adjust temperature setting.
- The LCD display will flash for approximately 8 seconds after temperature setting is complete then return to the main LCD display screen. The thermostat will now begin to execute the Manual function.
- Turn the rotary switch away from "START" then turn it back to "START" to terminate the Manual function.

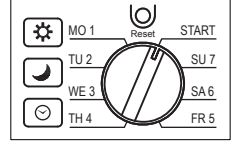

When in Comfort ☀ while setting the Manual function the thermostat will maintain executing Manual until the program runs to Economy 🌙. The same is true in Economy 🌙.

The ☀ and 🌙 icons will disappear from the LCD at the section of time the Manual function is operating.

5 Window Watcher™ mode (40° Set Point)

Any remote contacts can be used to activate the 40° set back. Multiple contacts can be placed in series so that if any break in the small 22 gauge control wire is sensed the thermostat will display "OFF" on the LCD window. As soon as the window contacts are closed the thermostat will resume operating like normal (the previous setting before the contacts were opened).

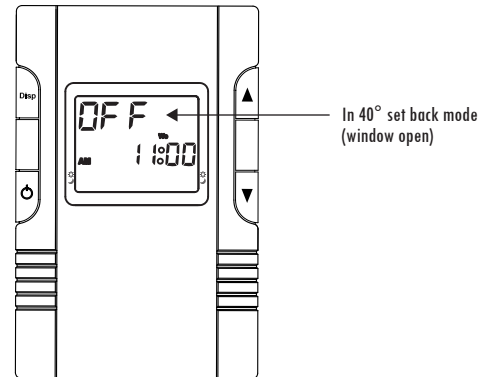

5 Motion Detector Interface (60° Set Point)

This second set of contacts will drop the set point to 60° if a break in the 22 gauge wire is sensed. Typically used with a motion sensor.

WIRING INSTRUCTIONS



WINDOW WATCHER™

WRP Series

System Matched for King heaters

⚠ DANGER ⚠

ELECTRIC SHOCK OR FIRE HAZARD

READ ALL WIRE SIZING, VOLTAGE REQUIREMENTS AND SAFETY DATA TO AVOID PROPERTY DAMAGE AND PERSONAL INJURY



1. To wire the thermostat determine which pair of wires are coming from the breaker panel and which pair lead to the heater.
2. Take a black lead from the circuit breaker panel and attach it to the black lead on the thermostat.
3. Take the black lead that goes to the heater and attach it to the red lead on the thermostat. This will provide power to the heater when the thermostat calls for heat. Attach the blue wire to the white wires.
4. Remove cover of thermostat by placing thumb on LCD display and forefinger on top of cover, pulling cover back to expose mounting screws and programming buttons. Slide battery cover off to expose lower mounting screw.
5. Push the wires carefully into the junction box making sure no wires are pinched or obstruct the screws mounting the thermostat. Now attach the thermostat to the wall with the #6-32 Phillips head screws provided.
6. Hold thermostat in wallbox and place screws in top and bottom mounting hole. Attach to wallbox. Install batteries and replace cover.
7. Turn on power. Test by increasing set point to higher than room temperature by tapping the ▲ Up button. There will be up to a 3 minute delay turning on. You will hear a small click and "Heater On" will appear on the LCD; the heater should now be on. Turn the thermostat down by tapping on the ▼ Down arrow.
8. **Differential Adjustment:** Hold both temperature ▲ and ▼ buttons for 10 seconds. The screen will go blank then show one digit. This is the number of degrees that the thermostat will over or undershoot the desired temperature. Adjust the setting between 1° and 4° by tapping the ▲ or ▼ arrow. Adjust to suit your comfort level.

* To change the display from Fahrenheit to Celsius requires opening the thermostat and moving a small jumper on circuit board. For assistance please contact the factory at (800) 603-5464 ext. 111

The small 22 gauge wire connection on the back of the thermostat is for the remote 40° or 60° activation. This is a volt-free set of control wires that can be used with any switch, such as: window and door contacts, motion sensors, key cards, hotel panels and anything that can make or break contact. 40° set back is activated on contact open.

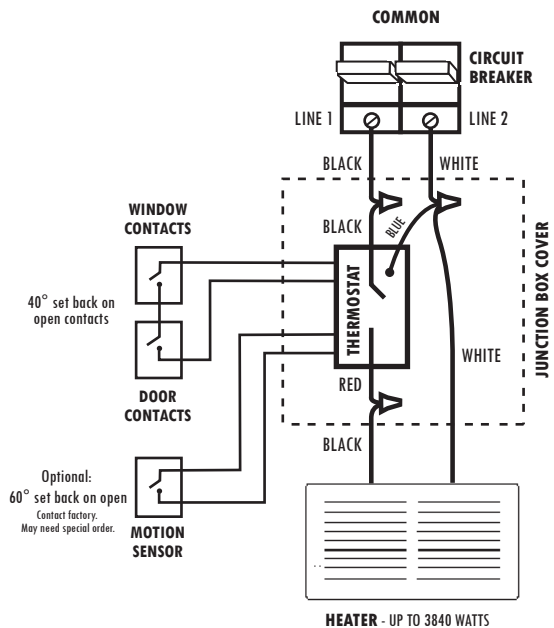
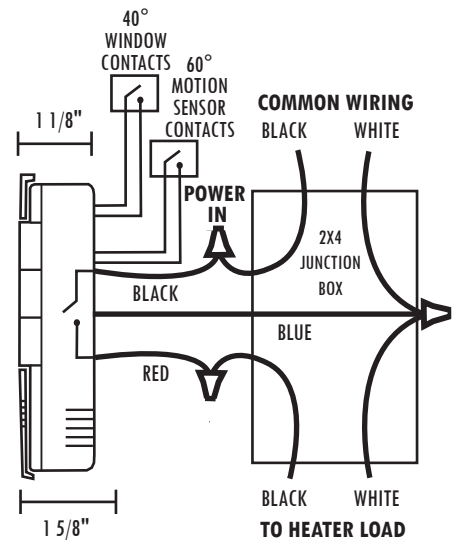

DIMENSIONS:

